

# HURRICANE MILTON

## Winter Park storm information

### HURRICANE MILTON UPDATE #3

Monday, October 7, 2024 @ 6:45 p.m.

#### CITY OF WINTER PARK EMERGENCY OPERATIONS CENTER

- The city's Emergency Operations Center (EOC) is currently at Level 3 – Monitoring and will transition to Level 2 – Partial Activation, Tuesday, October 8.
- The Non-Emergency Call Center [407-599-3494](tel:407-599-3494) and email [messagecenter@cityofwinterpark.org](mailto:messagecenter@cityofwinterpark.org) will be activated at 8 a.m., Wednesday, October 9, for non-emergency, storm-related calls.

#### CITY HALL & PUBLIC MEETINGS

- City Hall and all administrative offices will be closed October 9 and 10.
- All advisory board meetings scheduled for October 9 and 10, are cancelled.
- The October 9 CRA and City Commission meetings have been rescheduled to Thursday, October 17.
- The October 10 City Commission Work Session has been rescheduled to Wednesday, October 24.
- All building inspections are suspended for October 9 and 10.

An assessment will be made after the storm to determine when normal business hours and functions will resume.

#### SANDBAG DISTRIBUTION – CITY OF WINTER PARK RESIDENTS ONLY

- Date: October 8, from 8 a.m. to noon
- Location (map attached): Ward Park/Showalter Field Parking Lot | [288 Perth Lane](#) | enter site via Perth Lane
- Quantity (while supplies last)
  - Limit of eight per resident or business owner within the city limits.
  - Please **bring a proof of residency**, such as driver's license, valid ID or utility bill statement.

Please be prepared for a Fill-It-Yourself model with the city providing shovels, bags and sand on a first-come, first-served basis. If you are physically unable to fill your sandbags, city staff will be available to assist those in need.

#### PARKS & RECREATION UPDATES

- All parks & facilities will be closed October 9, until further notice.
- Dinky Dock will close @ noon on October 9.

#### WASTE PRO® SERVICES

- There will be garbage pickup October 8.
- Waste Pro has not made a decision regarding yard waste pick up on October 9. This notice will be updated once a decision has been made.
- On October 8, Orange County residents can bring excess yard waste to the Orange County Landfill located at [5901 Young Pine Road](#) during regular operating hours (8 a.m. to 5 p.m.), and residential yard waste fees will be waived. Access [ocfl.net/WasteSites](http://ocfl.net/WasteSites) for more information.
- Any items placed at the curb can become dangerous projectiles. Please store your items and any debris in a safe place until after the storm.

#### REPORT OUTAGES

- Electric utility power outages [1-877-811-8700](tel:1-877-811-8700) | Water & wastewater utilities outages [407-599-3219](tel:407-599-3219)

#### REMINDERS

- During and after the storm, do not wander outside to sight-see until the area is declared safe.
- Never approach a loose/hanging/downed power line as it may be energized. Report them immediately.
- Please minimize indoor water usage and turn off irrigation systems.

Website [cityofwinterpark.org/hurricanes](http://cityofwinterpark.org/hurricanes) Facebook [facebook.com/WinterParkEmergencyInfo](https://facebook.com/WinterParkEmergencyInfo)

X [x.com/winterparkfla](https://x.com/winterparkfla) Nextdoor [nextdoor.com](https://nextdoor.com) citEnews [cityofwinterpark.org/citEnews](https://cityofwinterpark.org/citEnews)

Email [messagecenter@cityofwinterpark.org](mailto:messagecenter@cityofwinterpark.org) Phone [407-599-3494](tel:407-599-3494)

**Media Contacts:** Clarissa Howard [407-599-3428](tel:407-599-3428) or cell [407-948-2044](tel:407-948-2044) | Craig O'Neil [407-599-3506](tel:407-599-3506) or cell [321-303-2653](tel:321-303-2653)

# Sandbag Distribution Map

## City of Winter Park Sandbag Distribution



### Location

Ward Park/Showalter Stadium Parking Lot | 288 Perth Lane

Enter site via Perth Lane

Exit site via Cady Way

### Date

Tuesday, October 8, from 8 a.m. to noon

### Quantity (while supplies last)

- Limit of eight per resident or business owner within the city limits.
- Please bring a proof of residency - driver's license, valid ID or utility bill statement.

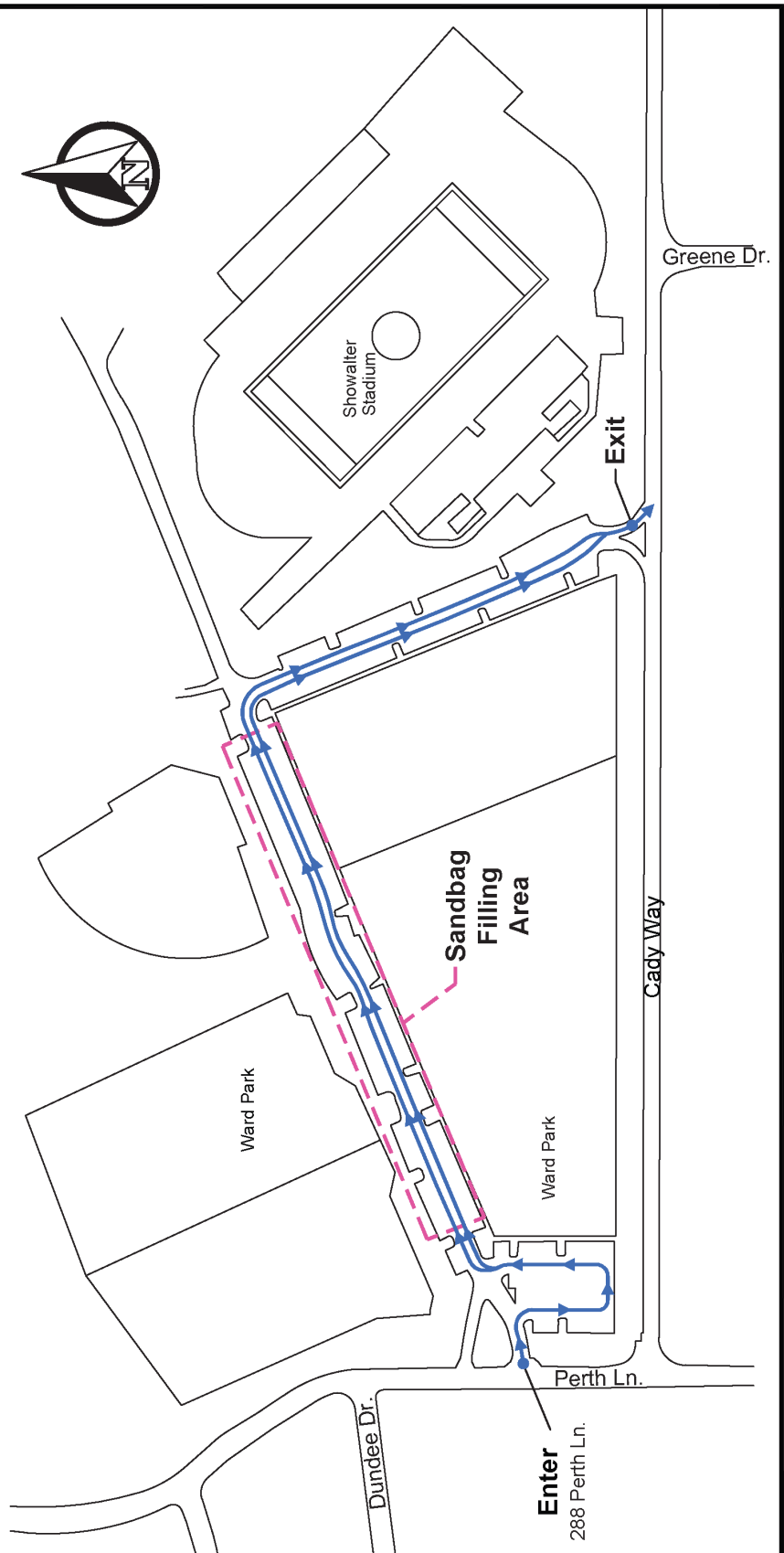

Website [cityofwinterpark.org/hurricanes](http://cityofwinterpark.org/hurricanes) Facebook [facebook.com/WinterParkEmergencyInfo](https://facebook.com/WinterParkEmergencyInfo)  
X [x.com/winterparkfla](https://x.com/winterparkfla) Nextdoor [nextdoor.com](https://nextdoor.com) citEnews [cityofwinterpark.org/citEnews](https://cityofwinterpark.org/citEnews)

Email [messagecenter@cityofwinterpark.org](mailto:messagecenter@cityofwinterpark.org) Phone 407-599-3494

**Media Contacts:** Clarissa Howard [407-599-3428](tel:407-599-3428) or cell [407-948-2044](tel:407-948-2044) | Craig O'Neil [407-599-3506](tel:407-599-3506) or cell [321-303-2653](tel:321-303-2653)