

After Recording Return To:
City of Winter Park, City Clerk's Office
401 Park Avenue South
Winter Park, Florida 32789

ORDINANCE NO. 2891-12

AN ORDINANCE OF THE CITY OF WINTER PARK, FLORIDA PARTIALLY VACATING AND ABANDONING THE EASEMENT LOCATED AT 901 NORTH ORLANDO AVENUE, WINTER PARK, FLORIDA, MORE PARTICULARLY DESCRIBED HEREIN, PROVIDING AN EFFECTIVE DATE.

WHEREAS, the City of Winter Park by custom will abandon an easement no longer needed for municipal purposes; and

WHEREAS, the City has determined that the easement or part thereof is no longer needed by the City of Winter Park.

NOW, THEREFORE, BE IT ENACTED by the People of the City of Winter Park, Florida as follows:

Section 1. The City Commission of the City of Winter Park, Florida, subject to the partial reservation of an easement provided in Section 3 hereof, does hereby vacate and abandon that certain utility easement located at 901 North Orlando Avenue, Winter Park, Florida, more particularly described as follows:

A portion of 901 North Orlando Avenue, Winter Park, Florida, according to the plat thereof recorded in O.R. Book 1524, Page 707, Public Records of Orange County, Florida, more particularly described as follows:

From the Northeast corner of Lot 2 of LORD'S SUBDIVISION as recorded in Plat Book P, Page 89, Public Records of Orange County, Florida, run S. 01' 25' W. along the East line of said Lot 2 a distance of 231.50 feet, thence N. 88° 53' 44" W. parallel with the North line of said Lot 166.17 feet to the point of beginning: Continue thence N. 88° 53' 44" W. 191.83 feet to a point on the Easterly right-of-way line of a county road now known as Webster Avenue, thence S. 1° 25' W. 260 feet along said Easterly right-of-way line, thence S. 88° 53' 44" E. Parallel with the North line of said Lot 2 a distance of 148 feet, thence N. 1° 25' E. 30 feet, thence S. 88° 53' 44" E. parallel with the North line of said Lot 210 feet to a point on the Westerly right-of-way line of State Road No. 15-600 and East line of Lot 2; thence N. 1° 25' E. along said line 71.61 feet, thence N. 6° 37' 44" W. along said Westerly right-of-way line 38.74 feet, thence N. 88° 53' 44" W. parallel with the North line of said Lot 2 160.09 feet, thence N. 1° 06' 16" E. 120 feet to the point of beginning, all lying and being in the NE¼ of Section 1, Township 22 South, Range 29 East;

Section 2. All ordinances or portions of ordinances in conflict herewith are hereby repealed.

Section 3. This is a partial vacation of easement subject to the following: The easement is vacated partially and only to the extent shown in the drawing attached as Exhibit "A" hereto showing in crosshatch the area of the easement that is being vacated and abandoned as it is no longer used or necessary for use by the City of Winter Park, Grantor

herein. The area reserved is for the service, maintenance, installation, and/or provision of utility services and upgrades.

Section 4. The parties intend that any error in legal description or in depiction of the portion of the easement vacated and abandoned may be corrected by subsequent curative document if the parties agree that there was an error in the survey, description, or in Exhibit "A".

Section 5. This ordinance shall take effect immediately upon its passage and adoption.

ADOPTED at a regular meeting of the City Commission of the City of Winter Park, Florida, held at City Hall, Winter Park, Florida, on the 12th day of November, 2012.

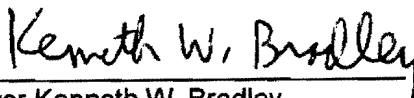

Mayor Kenneth W. Bradley

ATTEST:



City Clerk Cynthia S. Bonham

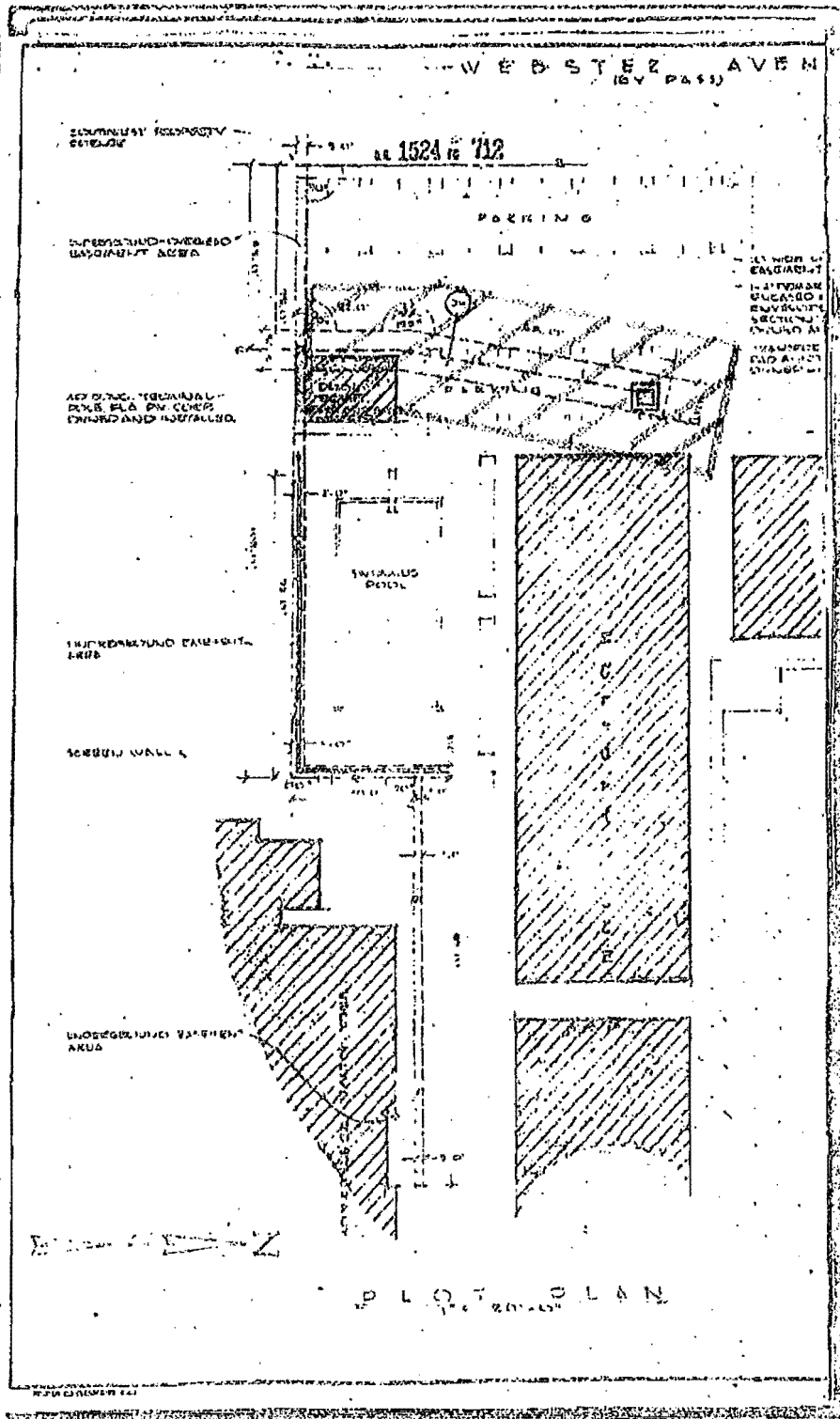

EXHIBIT
A