

ORDINANCE NO. 2701-07

**AN ORDINANCE OF THE CITY OF WINTER PARK,
FLORIDA AMENDING WITHIN THE CHARTER LAWS OF
THE CITY OF WINTER PARK, SECTION 1.02,
"CORPORATE LIMITS DESCRIBED" SO AS TO ANNEX
THE PROPERTY AT 509 LIGHTNING TRAIL THEREOF,
MORE PARTICULARLY DESCRIBED HEREIN.**

BE IT ENACTED BY THE PEOPLE OF THE CITY OF WINTER PARK:

SECTION 1. That Section 1.02 "Corporate Limits Described," of the Charter Laws of the City of Winter Park be hereby amended and modified so as to annex the property at 509 Lightning Trail thereof, more particularly described as follows:

That portion of the NE $\frac{1}{4}$ of the SE $\frac{1}{4}$, Section 29, Township 21 South, Range 30 East, lying Northwesterly of the present center line of the creek or branch which traverses the Northwesterly corner of said NE $\frac{1}{4}$ of the SE $\frac{1}{4}$ of said section, in Orange County, Florida, LESS an easement for utilities over and under the West 25 feet thereof, LESS Beginning at the Southwest corner of Lot 1, Block "E", DOMMERICH HILLS, SECOND ADDITION, according to the plat thereof as recorded in Plat Book Z, Page 48, Public Records of Orange County, Florida, and running South $0^{\circ}22'56''$ West a distance of 11.05 feet; thence parallel with the southern boundary of said lot South $89^{\circ}32'35''$ East a distance of 355.47 feet; thence North $0^{\circ}22'57''$ East to the Southern Boundary of said lot North $89^{\circ}32'35''$ West 355.47 feet to point of beginning.

SECTION 2. This ordinance shall take effect immediately upon its adoption.

ADOPTED at a regular meeting of the City Commission of the City of Winter Park, Florida, held in City Hall, Winter Park, on this 26th day of March, 2007.

Attest:



Mayor David C. Strong



Deputy City Clerk

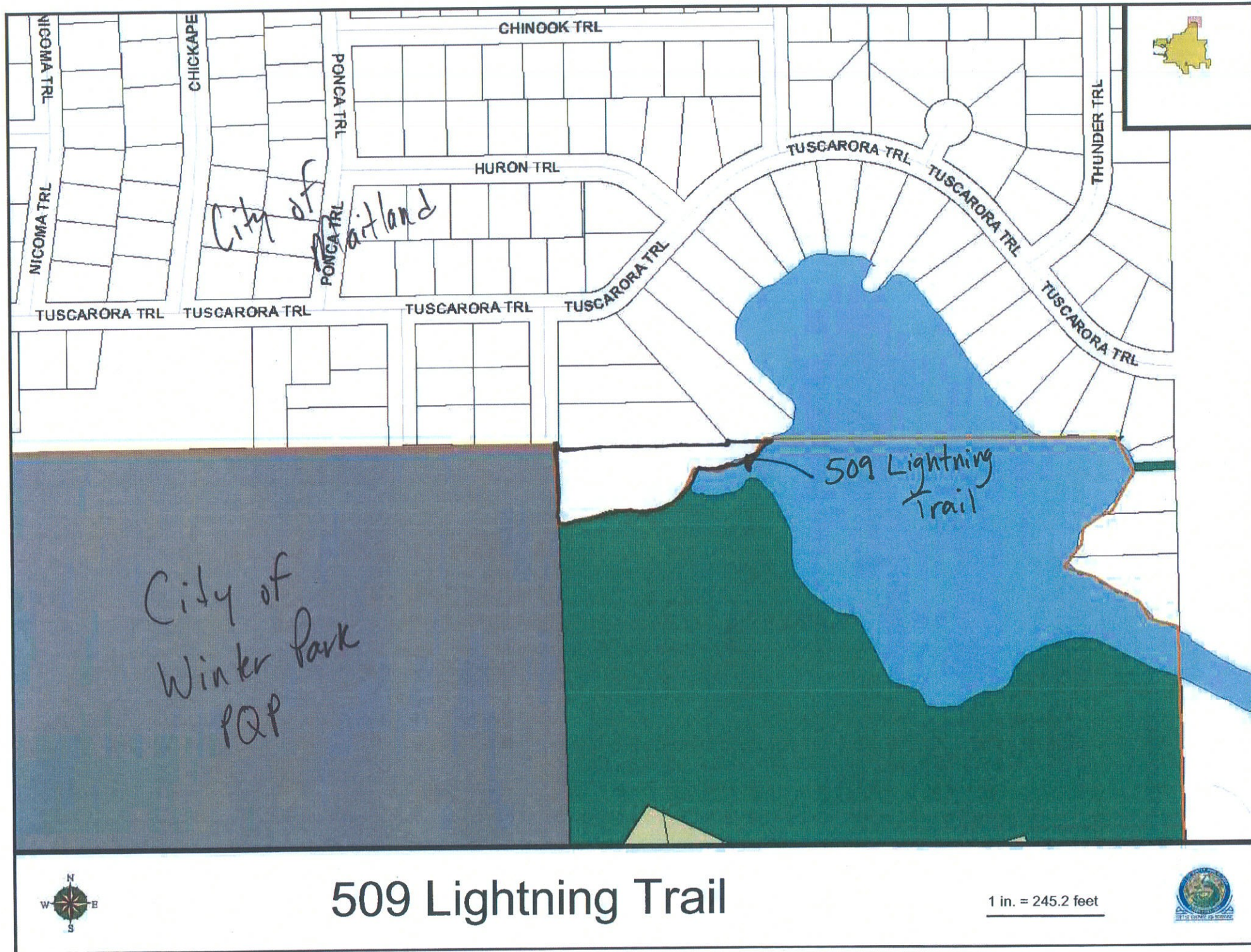

509 Lightning Trail

1 in. = 245.2 feet

