

RESOLUTION NO. 2028-09

**A RESOLUTION OF THE CITY OF WINTER PARK, FLORIDA,
ADOPTING POLICY ASSURANCES REGARDING THE FUTURE
ANNEXATION OF THE STONEHURST DRIVE AND KINGS WAY
ENCLAVE.**

WHEREAS, the Florida Statutes Chapter 171 provides the statutory regulations for annexations and encourages cities to annex enclaves of unincorporated areas that are completely surrounded by municipalities in order to more efficiently provide services to those areas; and

WHEREAS, the Winter Park Comprehensive Plan and Strategic Plan indicate that the Stonehurst Drive and Kings Way enclave is a priority area for the City to annex; and

WHEREAS, the residents on this area desire some assurances as to policy matters concerning the future provision of city services to be codified for future city commissions to understand the terms and conditions that were given regarding these issues.

NOW, THEREFORE, be it Resolved by the City Commission of the City of Winter Park, Florida:

SECTION 1. The Winter Park City Commission does hereby adopt as policy that sanitary sewer and sidewalks shall not be further constructed or extended within the streets or properties within the Stonehurst Drive and Kings Way enclave area as depicted and attached as Exhibit "A".

SECTION 2. The Winter Park City Commission does hereby adopt as policy its' intention to reduce the width of the Stonehurst Drive right-of-way from 90 feet wide to 60 feet wide via a future ordinance to vacate and abandon 15 feet on each side of the right-of-way thereby increasing the private property of the homes fronting on Stonehurst Drive.

SECTION 3. This Resolution shall become effective upon its passage and the annexation of the Stonehurst Drive and Kings Way enclave.

ADOPTED at a regular meeting of the City Commission of the City of Winter Park held in City Hall, Winter Park on this 27th day of July, 2009.

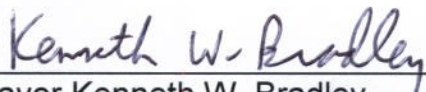
Mayor Kenneth W. Bradley

ATTEST:

Deputy City Clerk Nancy McLean

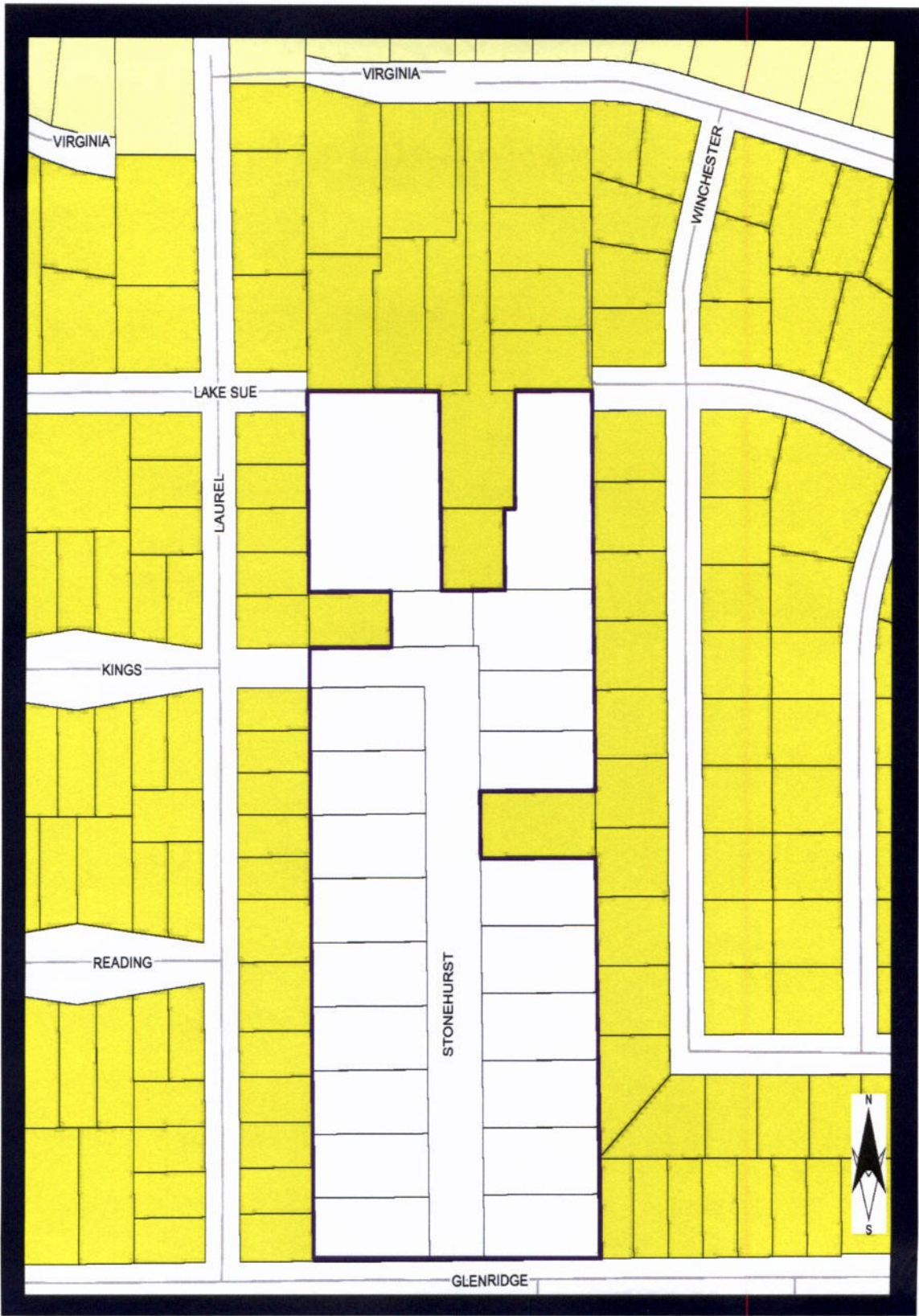

Stonehurst Drive/ Kings Way Enclave