

CITY OF WINTER PARK

WATER & WASTEWATER UTILITY DEPARTMENT

REFERENCE THE "WATER & WASTEWATER UTILITY STANDARDS, SPECIFICATIONS & DETAILS MANUAL"

DATE: January 2, 2008

VALVE COLLAR PAD

SCALE: N.T.S

UNIMPROVED CONDITION

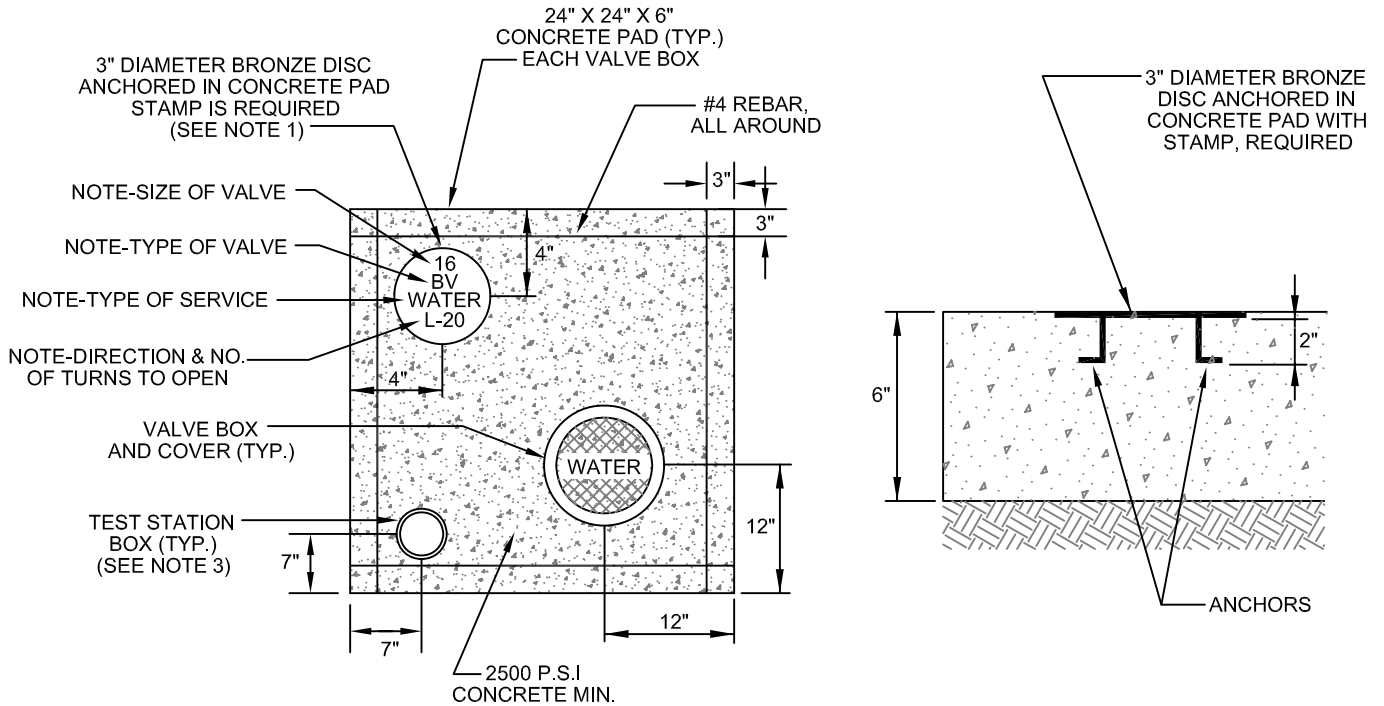

IMPROVED CONDITION

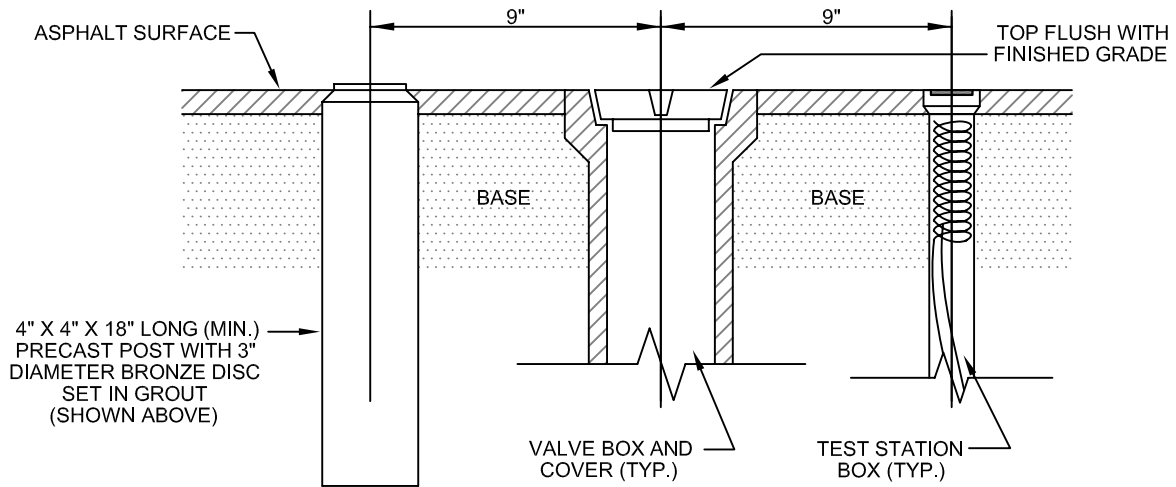

NOTES:

1. BRONZE IDENTIFICATION DISC SHALL BE REQUIRED FOR ALL VALVES GREATER THAN 2", OR AS REQUIRED BY THE CITY.
2. VALVE COLLAR DIMENSIONS MAY BE REDUCED TO 18" X 18" X 6" ON A 2" ARCH PATTERN CURB BOX.
3. SEE FIGURE 42 FOR DETAILED SPECIFICATIONS.

FIGURE 10