

The Alfond Inn - Phase 2 Conceptual Rendering



CITY OF WINTER PARK
401 South Park Avenue
Winter Park, FL 32789

PRE-SORTED
STANDARD
U.S. Postage
PAID
Orlando, FL
Permit No. 4834

PUBLIC NOTICE



THE ALFOND INN EXPANSION 300 E. NEW ENGLAND AVE.

PUBLIC HEARINGS

2019

Planning & Zoning Board
TUESDAY 02.05.19 @ 6 p.m.

City Commission
MONDAY 02.25.19 @ 3:30 p.m.

City Hall Commission Chambers
2nd Floor | 401 S. Park Ave.
Winter Park, Florida 32789

Rollins College is requesting approval of a Conditional Use permit for Phase 2 of The Alfond Inn pursuant to the Developer's Agreement (as amended) between the City of Winter Park and Rollins College, dated December 16, 2011.

Phase 2 includes:

- 73 hotel rooms
- 323 sq. ft. retail space
- 12,000 sq. ft. spa/health club
- 2,140 sq. ft. meeting space/gallery
- Parking spaces will be split between both on-site and off-site at Rollins SunTrust Parking Garage

NOTE: If a person decides to appeal any decision made by the Commission with respect to any matter considered at such meeting or hearing, he/she will need a record of the proceedings, and that, for such purpose, he/she may need to ensure that a verbatim record of the proceedings is made, which record includes the testimony and evidence upon which the appeal is to be based. (F.S. 286.0105).

Persons with disabilities needing assistance to participate in any of these proceedings should contact the Planning & Community Development Department at 407-599-3324 at least 48 hours in advance of the meeting.

The Alfond Inn ■ Phase 2 Site Plan & Conceptual Rendering

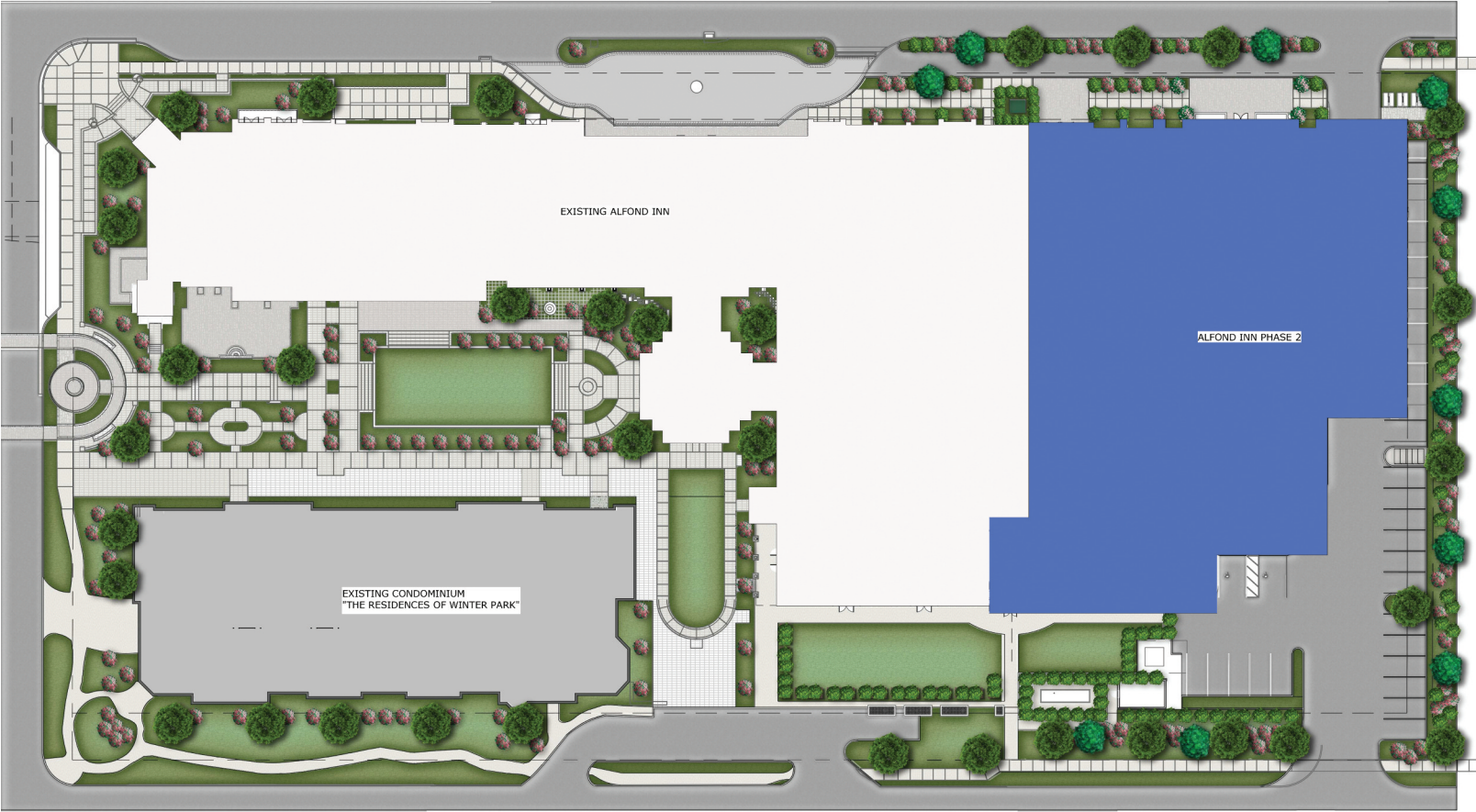

view from New England Avenue looking west

Use	Approved	Phase 1	Phase 2	Remaining
Hotel Rooms & Suites	250	112	73	65
Restaurant, Lobby & Pool Bars	5,200 sq. ft.	5,200 sq. ft.	0 sq. ft.	0 sq. ft.
Retail	323 sq. ft.	0 sq. ft.	323 sq. ft.	0 sq. ft.
Ballroom/Banquet/Meeting Space	14,570 sq. ft.	8,900 sq. ft.	2,140 sq. ft.	5,456 sq. ft.
Spa/Health Club	12,000 sq. ft.	0 sq. ft.	12,000 sq. ft.	0 sq. ft.